

EXPRES CUT S35K

CE EN60974-7



CODE	↔		
PAS104M-096-WB3	4 m	12.5'	DIRECT 4 WIRES

TECHNICAL DATA		
NO HF	EXPRES CUT S35K	
1 m	0,4 kg	0,88 lb
PEAK	500	
	2,5 bar	
	60 l/min	
35%	32 A	
	6-8 mm	1/4" - 5/16"

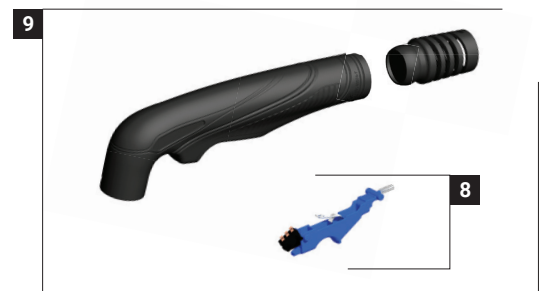

K Series Torches for Integrated Compressors

Plasma Cutting Machine

K Expresscut Torch

CIRCLE CUTTING GUIDE KIT CV0025

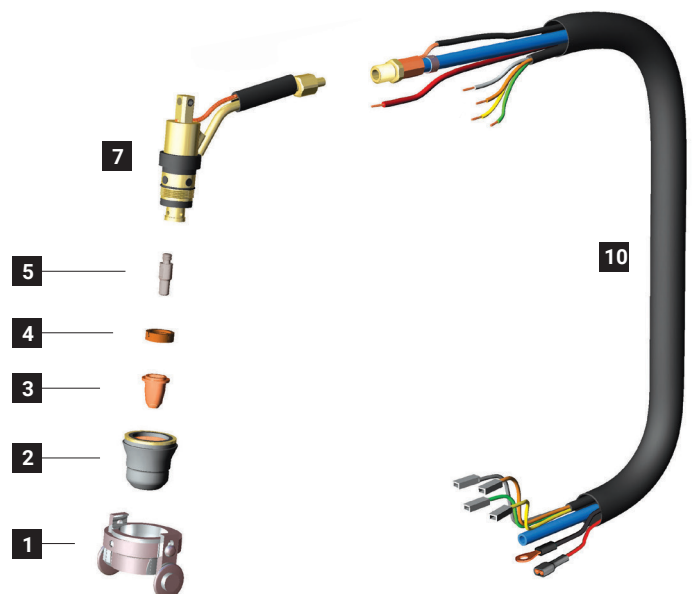

	CODE		Description	Ø		↔		CONTACT		DRAG		GOUGING	REF	
1	CV0024		stand off guide	23,5 mm		33 mm		•						1
2	PC0135		nozzle (2 rings)			28 mm		•	•					4
3	PD0103-09		40 A	0,9 mm	.035"	25,8 mm			•					10
3	PD0103-65		20 A	0,65 mm	.025"	25,8 mm			•					10
3	PD0116-06		20 A	0,6 mm	.023"	17,3 mm		•						10
3	PD0116-08		30 A	0,8 mm	.030"	17,3 mm		•						10
3	PD0116-09		40 A	0,9 mm	.035"	17,3 mm		•						10
4	PE0106		Swirl ring			4,6 mm		•	•				60028	2
5	PR0106		electrode			30,5 mm			•					10
5	PR0110		electrode			21,8 mm		•						10

	CODE		Description	
7	EA0330		o-ring	10
7	PF0127		S25K - S35K - S25 - S45 torch head	1
8	TP0310		trigger kit	1

	CODE		Description	
9	TP0301		handle kit	1
9	BW0424		spring joint	1
10	PH4015		cable assembly - 4 m / 12' - direct 4 wires	1

STANDARD CONTACT SHORT CONTACT LONG DRAG SHORT DRAG LONG GOUGING