

ERGOPLUS 500 SPECIAL

CE EN60974-7



| CODE | | | | | |
|-----------------|--------------|-----|-------|----------|---|
| MB2602-030-5010 | MG0282-10-SP | 3 m | 10' | EURO | 1 |
| MB2602-040-5010 | MG0282-10-SP | 4 m | 12' | | 1 |
| MB2602-050-5010 | MG0282-10-SP | 5 m | 16.4' | | 1 |
| MB2602-030-5016 | MG0282-16-SP | 3 m | 10' | | 1 |
| MB2602-040-5016 | MG0282-16-SP | 4 m | 12' | | 1 |
| MB2602-050-5016 | MG0282-16-SP | 5 m | 16.4' | | 1 |
| MB2602-030-5030 | MG0282-30-SP | 3 m | 10' | | 1 |
| MB2602-040-5030 | MG0282-30-SP | 4 m | 12' | | 1 |
| MB2602-050-5030 | MG0282-30-SP | 5 m | 16.4' | | 1 |
| MB2602-030-5050 | MG0282-50-SP | 3 m | 10' | | 1 |
| MB2602-040-5050 | MG0282-50-SP | 4 m | 12' | | 1 |
| MB2602-050-5050 | MG0282-50-SP | 5 m | 16.4' | | 1 |
| MB2602-030-5070 | MG0282-70-SP | 3 m | 10' | | 1 |
| MB2602-040-5070 | MG0282-70-SP | 4 m | 12' | | 1 |
| MB2602-050-5070 | MG0282-70-SP | 5 m | 16.4' | | 1 |

| TECHNICAL DATA | | |
|---------------------|---------------------|---------------|
| ERGOPLUS 500 | | |
| | 1,25 kg | 2.76 lb |
| | 113 | |
| | 1,0 ÷ 2,4 mm | .040" ÷ 3/32" |
| | 500A CO2 - 450A Mix | |
| | 2÷4 bar | |
| | 1,6 l/min | |

MIG *Standard equipment in all torch packages*

MT0566

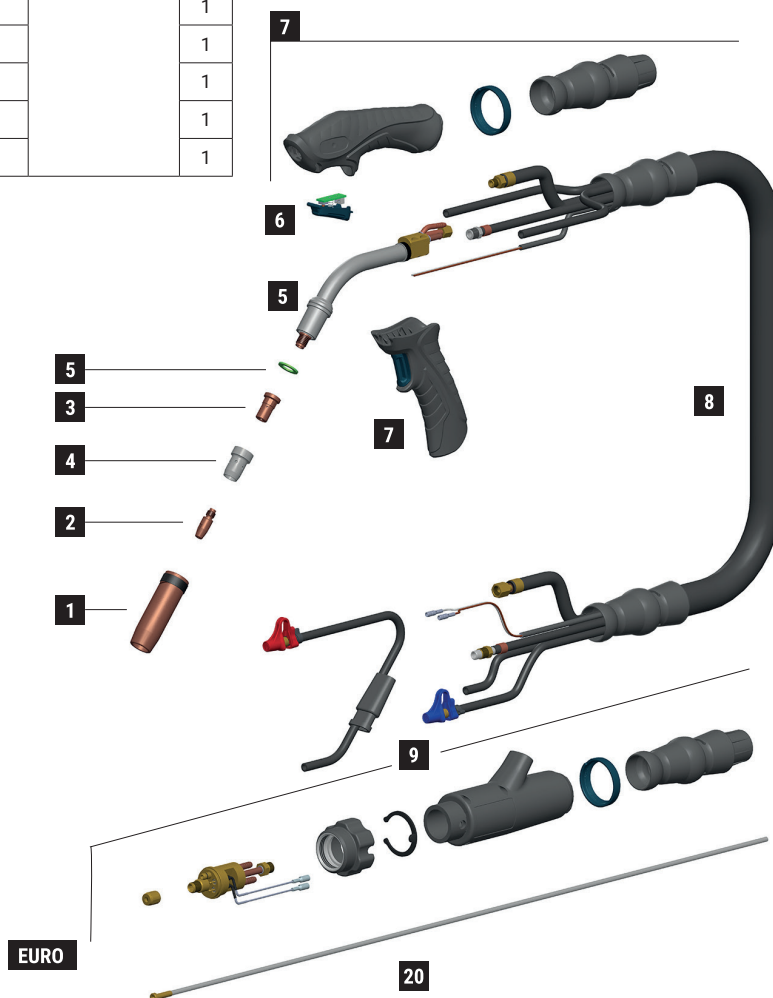

| | CODE | | | Ø | | ↔ | | REF | |
|----|-----------|--|--|--------------|---------------|-------|---------|----------|----|
| 1 | MC0568 | | quick release nozzle - 2,5 mm thickness | 16 mm | 5/8" | 76 mm | 3" | - | 10 |
| 2 | MD0005-82 | | M8 - CuCrZr | 1,2 mm | .045" | 30 mm | 1"-3/16 | 140.0445 | 20 |
| 3 | ME0390 | | M8 - copper | | | 25 mm | 31/32" | - | 10 |
| 4 | ME0579 | | ceramic | 16 mm | 5/8" | 28 mm | 1"-3/32 | - | 10 |
| 20 | GM0530 | | uncoated steel liner | 1,2 ÷ 1,6 mm | .045" ÷ 1/16" | 3 m | 10' | | 1 |
| 20 | GM0531 | | uncoated steel liner | 1,2 ÷ 1,6 mm | .045" ÷ 1/16" | 4 m | 12' | | 1 |
| 20 | GM0532 | | uncoated steel liner | 1,2 ÷ 1,6 mm | .045" ÷ 1/16" | 5 m | 16.4' | | 1 |

***Complete list of available consumables at the end of this section**

| | CODE | | | |
|---|--------------|--|--|----|
| 5 | FB1278 | | Insulator | 10 |
| 5 | MG0282-10-SP | | Ergoplus 500 torch head 100 mm | 1 |
| 5 | MG0282-16-SP | | Ergoplus 500 torch head 160 mm | 1 |
| 6 | MG0282-30-SP | | Ergoplus 500 torch head 300 mm | 1 |
| 5 | MG0282-50-SP | | Ergoplus 500 torch head 500 mm | 1 |
| 5 | MG0282-70-SP | | Ergoplus 500 torch head 700 mm | 1 |
| 7 | MT0563 | | trigger kit | 1 |
| 7 | MT0560 | | handle kit | 1 |
| 7 | MT0566 | | pistol grip | 1 |
| 8 | MN2014-030 | | cable assembly - 3 m / 10' with ball-joints | 1 |
| 8 | MN2014-040 | | cable assembly - 4 m / 12' | 1 |

| | CODE | | | |
|---|------------|--|------------------------------|----|
| 8 | MN2014-050 | | cable assembly - 5 m / 16.4' | 1 |
| 9 | AR0052 | | EURO connector | 1 |
| 9 | BW0020 | | metal EURO nut | 10 |
| 9 | FA0026 | | liner nut M10x1 | 10 |
| 9 | MT0564 | | back box kit | 1 |

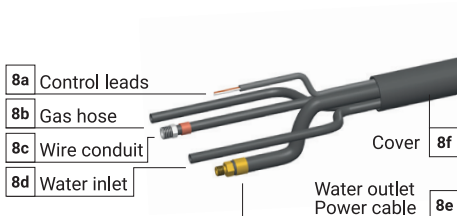

| | CODE | ↔ |
|----|------------|-----------|
| 8a | BX1421-030 | 3 m / 10' |
| 8b | QB0231-030 | 3 m / 10' |
| 8c | QB0230-030 | 3 m / 10' |
| 8d | QB0232-030 | 3 m / 10' |
| 8e | QA0030-030 | 3 m / 10' |
| 8f | MQ0125-030 | 3 m / 10' |

| | CODE | ↔ |
|----|------------|-----------|
| 8a | BX1421-040 | 4 m / 12' |
| 8b | QB0231-040 | 4 m / 12' |
| 8c | QB0230-040 | 4 m / 12' |
| 8d | QB0232-040 | 4 m / 12' |
| 8e | QA0030-040 | 4 m / 12' |
| 8f | MQ0125-040 | 4 m / 12' |

| | CODE | ↔ |
|----|------------|-------------|
| 8a | BX1421-050 | 5 m / 16.4' |
| 8b | QB0231-050 | 5 m / 16.4' |
| 8c | QB0230-050 | 5 m / 16.4' |
| 8d | QB0232-050 | 5 m / 16.4' |
| 8e | QA0030-050 | 5 m / 16.4' |
| 8f | MQ0125-050 | 5 m / 16.4' |

STANDARD