

ERGOPLUS 500

CE EN60974-7



CODE					
MB2602-030	50°	3 m	10'	 EURO	1
MB2602-040	50°	4 m	12'		1
MB2602-050	50°	5 m	16.4'		1
MB2602-060	50°	6 m	19.6'		1
MB2602-080	50°	8 m	26.2'		1
MB2602-030-3000	30°	3 m	10'		1
MB2602-040-3000	30°	4 m	12'		1
MB2602-050-3000	30°	5 m	16.4'		1

TECHNICAL DATA		
	ERGOPLUS 500	
	1,4 kg	3.09 lb
	113	
	1,0 ÷ 1,6 mm	.040" ÷ 1/16"
	500A CO2 - 450A Mix	
	2÷4 bar	
	1,6 l/min	

MIG *Standard equipment in all torch packages*

MT0566

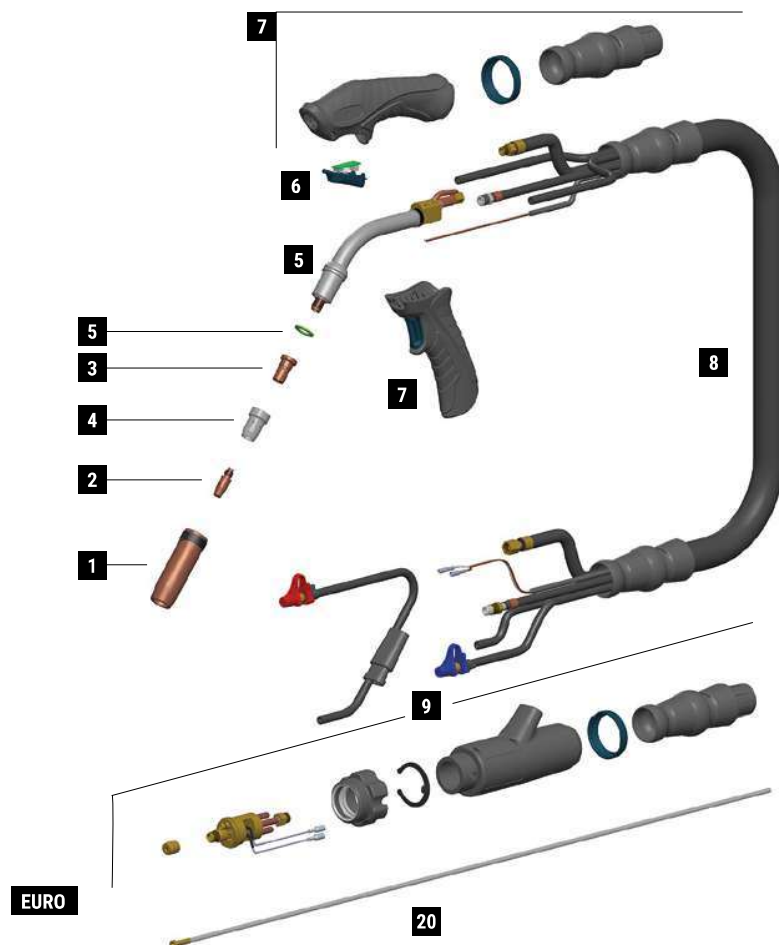

	CODE			Ø		↔		REF	
1	MC0568		quick release nozzle - 2,5 mm thickness	16 mm	5/8"	76 mm	3"	-	10
2	MD0005-82		M8 - CuCrZr	1,2 mm	.045"	30 mm	1"-3/16	140.0445	20
3	ME0390		M8 - copper			25 mm	31/32"	-	10
4	ME0579		ceramic			28 mm	1"-3/32	-	10
20	GM0530		uncoated steel liner	1,2 ÷ 1,6 mm	.045" ÷ 1/16"	3 m	10'		1
20	GM0531		uncoated steel liner	1,2 ÷ 1,6 mm	.045" ÷ 1/16"	4 m	12'		1
20	GM0532		uncoated steel liner	1,2 ÷ 1,6 mm	.045" ÷ 1/16"	5 m	16.4'		1
20	GM0533		uncoated steel liner	1,2 ÷ 1,6 mm	.045" ÷ 1/16"	6 m	19.6'		1
20	GM0785		yellow teflon liner with copper terminal	1,2 ÷ 1,6 mm	.045" ÷ 1/16"	8 m	26.2'		1

***Complete list of available consumables at the end of this section**

	CODE			
5	FB1278		Insulator	10
5	MG0286		Ergoplus 500 torch head 50°	1
5	MG0295-SP		Ergoplus 500 torch head 30°	1
6	MT0563		trigger kit	1
7	MT0560		handle kit	1
7	MT0566		pistol grip	1
8	MN2014-030		cable assembly - 3 m / 10' with ball-joints	1
8	MN2014-040		cable assembly - 4 m / 12' with ball-joints	1

	CODE			
8	MN2014-050		cable assembly - 5 m / 16.4' with ball-joints	1
8	MN2014-060		cable assembly - 6 m / 19.6' with ball-joints	1
8	MN2014-080		cable assembly - 8 m / 26.2' with ball-joints	1
9	AR0052		EURO connector	1
9	BW0020		metal EURO nut	10
9	FA0026		liner nut M10x1	10
9	MT0564		back box kit	1

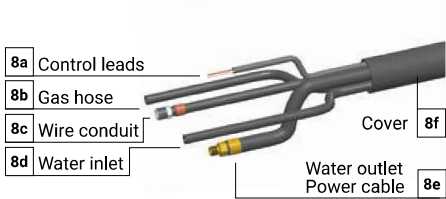

	CODE	↔
8a	BX1421-030	3 m / 10'
8b	QB0231-030	3 m / 10'
8c	QB0230-030	3 m / 10'
8d	QB0232-030	3 m / 10'
8e	QA0030-030	3 m / 10'
8f	MQ0125-030	3 m / 10'

	CODE	↔
8a	BX1421-040	4 m / 12'
8b	QB0231-040	4 m / 12'
8c	QB0230-040	4 m / 12'
8d	QB0232-040	4 m / 12'
8e	QA0030-040	4 m / 12'
8f	MQ0125-040	4 m / 12'

	CODE	↔
8a	BX1421-050	5 m / 16.4'
8b	QB0231-050	5 m / 16.4'
8c	QB0230-050	5 m / 16.4'
8d	QB0232-050	5 m / 16.4'
8e	QA0030-050	5 m / 16.4'
8f	MQ0125-050	5 m / 16.4'

	CODE	↔
8a	BX1421-060	6 m / 19.6'
8b	QB0231-060	6 m / 19.6'
8c	QB0230-060	6 m / 19.6'
8d	QB0232-060	6 m / 19.6'
8e	QA0030-060	6 m / 19.6'
8f	MQ0125-060	6 m / 19.6'

	CODE	↔
8a	BX1421-080	8 m / 26.2'
8b	QB0231-080	8 m / 26.2'
8c	QB0230-080	8 m / 26.2'
8d	QB0232-080	8 m / 26.2'
8e	QA0030-080	8 m / 26.2'
8f	MQ0125-080	8 m / 26.2'

CODE	X(mm)	Y(mm)	Z(°)	
MG0286	130	94	50	
MG0295-SP	153	66	30	

STANDARD